



WIRELOC™ CLAMP TYPE CONNECTOR

Wireloc™ Clamp Series - Design based on **ASME VIII Div. 1 & 2 Code Rules** and suitable for Pressure Vessel, Pig Launchers, Heat Exchangers, Separators, Sand Scrubbers, Closures and a multitude of Process Piping applications.

Advantages - Wireloc™ Clamp Connectors are completely interchangeable with Grayloc® type equivalent manufacturers, and offer over **80% Weight Savings** as well as significant Space savings compared to standard ASME B16.5 flanges. Wireloc™ is offered in sizes thru 60" (1,524mm) in comparison to ASME B16.47 and MSS-SP44 Standards, and are manufactured in a multitude of materials.

Size Range - ½" (12mm) thru 60" (1,524mm). Larger available on request.

Pressure & Temperature - ASME 600lbs thru 4,500lbs, API 5,000# thru 20,000#, and -452°F (-253°C) / +1600°F (871°C).

Materials - SA105, SA350-LF2, A694-F52-F70, AISI 4130, SA182-F316 (L,H), SA-182-F321 (L,H), SA182-F347 (L,H), A182-F51, A182-F55, Safurex, Alloy 625, Alloy 825, Titanium and Hastaloy.

Gasket - The Wireloc™ Clamp Type Pipe Connector uses an **all metal** Seal Ring with **over 50 years** of service history. Seal materials are selected based on application and service conditions. The **pressure energized** bore Seals are elastic by design, and therefore, **Reusable**.

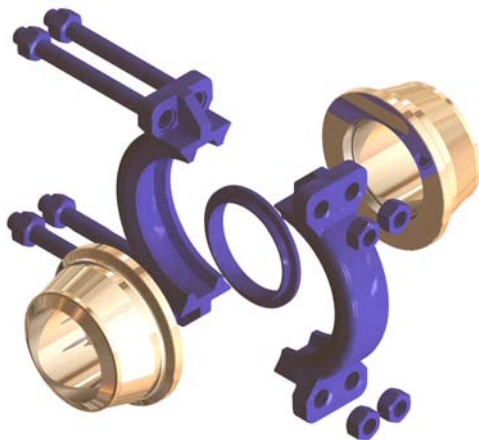

8" 2500# Wireloc™ Clamp Assembly (Sch. 160)

Total Weight: 228LBS (104KGS)

vs;

8" ASME 2500lbs Flange Assembly (Sch. 160)

Total Weight: 1359LBS (618KGS)

WIRELOC™ CLAMP SERIES 83% LESS WEIGHT

(actual scale, weights accurate to +/-2%)

Design & Engineering Support - LTS provides both ASME analytical calculation methods in accordance with **Section VIII Division 1 and 2 methods**, as well as **ANSYS FEA** analysis supporting dynamic load, combination loads and thermal load applications. LTS specializes in **High Pressure and High Temperature** solutions and offers integrated design analysis for skid and piping systems using in-house **CEASAR II** software.

Design Verification - Building on our extensive **HP/HT** experience, LTS offers Project specific **Prototype Testing**, as well as **Third Party** design review through DNV, Lloyds, ABS and Bureau Veritas, as required.